

# Contents

<b>Read First</b> .....	<b>6</b>
<b>Quick Start</b> .....	<b>10</b>
<b>Chapter 1 : Getting Started</b> .....	<b>12</b>
Camera Parts .....	12
Set Up .....	15
Attaching the Wrist Strap .....	15
Inserting the Battery & the Memory Card .....	16
Using the AC Adaptor .....	17
Turning on Power .....	18
Setting the Language .....	19
Setting the Date and Time .....	20
<b>Chapter 2 : Taking Pictures &amp; Recording Video Clips</b> .....	<b>21</b>
Using the LCD Display .....	21
Still Mode .....	22
Movie Mode .....	23
Changing the Contents on the LCD Monitor .....	23
Using Zoom .....	24
Optical Zoom .....	24
Digital Zoom .....	24
Taking Still Pictures .....	26
Using Auto Focus .....	26
Using Focus Lock .....	27
Macro Mode .....	28
Capture Mode .....	29
Night Scene .....	29
Sports .....	29
Portrait .....	30
Landscape .....	30
Setting Shutter Speed Priority .....	31
Setting Aperture Priority .....	32
Setting Program Mode .....	33

Setting Exposure Compensation . . . . .	34
Using Self-timer. . . . .	35
Using Built-in Flash . . . . .	36
<b>Recording Video Clips. . . . .</b>	<b>37</b>
Setting White Balance . . . . .	38
Setting Video Quality . . . . .	39
Setting Video Effect. . . . .	40
Setting Sharpness . . . . .	41
Setting Contrast . . . . .	42
Setting Saturation . . . . .	43
<b>Using the Capture Menu . . . . .</b>	<b>44</b>
Setting White Balance . . . . .	45
Setting ISO (Sensitivity) . . . . .	46
Setting Image Size (Resolution) . . . . .	47
Setting Picture Quality. . . . .	48
Setting Picture Effect. . . . .	49
Setting Sharpness . . . . .	50
Setting Contrast . . . . .	51
Setting Saturation . . . . .	52
Setting Exposure Area . . . . .	53
Taking Multiple Shots . . . . .	54
 <b>Chapter 3 : Playback Images and Video Clips. . . . .</b>	 <b>55</b>
<b>Using the LCD Display. . . . .</b>	<b>55</b>
<b>Using Playback . . . . .</b>	<b>56</b>
Viewing Still Images . . . . .	56
Activating Digital Enlargement . . . . .	58
<b>Using the Playback Menu. . . . .</b>	<b>59</b>
Deleting Images . . . . .	60
Protecting Pictures and Video Clips . . . . .	61
Recording Audio Clips for Still Images . . . . .	62
Setting DPOF (Digital Print Order Format). . . . .	64
Displaying a Slide Show. . . . .	65
Rotating the Images . . . . .	66
Selecting Your Start-up Screen Photo. . . . .	67

<b>Chapter 4: Installing the Software</b>	<b>68</b>
Windows System Requirements	69
Installing the Software	70
Installing the Driver	66
Installing the Application (Windows)	71
Using the Application	74
Digital Image	74
PhotoImpression	75
VideoImpression	76
<b>Chapter 5: Uploading, Printing, and Displaying Images</b>	<b>78</b>
Uploading to a Computer	78
Printing Images	79
Displaying images on a TV	80
<b>Chapter 6: Adjusting the Camera Settings</b>	<b>81</b>
Using the Set Up Menu	81
Setting Digital Zoom	82
Setting AF Illuminator	82
Format the Memory Card	83
Resetting File Number	84
Imprinting the Date and Time	85
Setting Camera Sound	86
Setting Camera Volume	86
Setting TV System	87
Setting Power Saving Function	88
Customizing Your Start-Up Screen	89
Resetting Your Camera	90
<b>Trouble Shooting</b>	<b>91</b>
<b>Specifications</b>	<b>93</b>

# Read First

Before using the camera, please make sure that you read and understand all of the following safety precautions. Always ensure that the camera is operated correctly. The safety precautions will instruct you in the safe and correct operation of the camera and its accessories, preventing injuries or damage to yourself, other persons or other equipment.

In the following pages, the term "equipment" refers mainly to the camera and its power supply accessories.



## WARNINGS

To prevent possible injury, please observe the following warnings when using this product.

- **Do not aim the viewfinder at the sun or other intense light.**

Aiming at the sun through the viewfinder could injure your eyesight.

- **Do not use the flash too close to eyes**

Using the flash too close to your subject's eyes can injure the eyesight.

Please, remain at least one meter (39 inches) away from infants when you use the flash.

- **Do not place camera strap around neck**

The strap could result in suffocation when accidentally wound around neck.

- **Do not open or disassemble**

Disassembling the equipment may cause high-voltage electrical shock.

Interior inspections, modifications and repairs should be conducted by qualified service staff. Please take the product to an authorised service centre for inspection.



---

- **Turn off immediately in cases of malfunction**

If you notice an unusual smell or see smoke coming from the equipment, please unplug the AC adaptor and remove the battery immediately. Proceed swiftly with caution to avoid burns. Take the equipment to an authorised service centre for inspection.

- **Unplug the adaptor when the camera is not in use**

If you use the adaptor as the power source, unplug the adaptor when the camera is not in use to prevent fire and other dangers. Continuous use over a long time may lead to overheating, deformation and fire.

## **Battery**

Observe the following instruction when handling battery used in this product. Improper use of battery may lead to leakage or explosion.

- Recharge only Li-ion rechargeable battery. Recharging battery that are not rechargeable may lead to leakage or explosion.
- Check battery polarity before inserting. Do not attempt to insert the battery upside down or backward.
- Do not disassemble or short circuit the battery.
- Do not expose battery to fire or excessive heat.
- Do not immerse or contact with water or other liquids.
- Stop using the battery immediately when noticing any deformation or changes in colour.
- Do not put the battery along with metal objects such as coins, keys or hair-pins in your pocket.
- Keep battery out of the children's reach. Seek medical attention right away if the child swallowed a battery.



## CAUTIONS

Observe and exercise the following cautions to avoid damage and keep your camera in an optimum working condition.

- **Keep dry**

This camera is not waterproof, and may malfunction when immersed in water, or any liquids enter the interior of the camera

- **Keep away from moisture, salt or dust**

Wipe off salt or dust with a slightly dampened soft cloth after using your camera at the beach, then dry your camera thoroughly.

- **Keep away from strong magnetic fields**

Never put the camera too close to any equipment producing strong electromagnetic fields, such as electric motor. Strong electromagnetic fields could lead camera malfunctions or interfere with the data recording.

- **Avoid intense heat**

Do not use or store the camera under sunlight or high temperatures. Such exposure could lead to the leakage of the battery or deformation of the casing.

- **Avoid rapid temperature change**

Rapidly moving the equipment between hot and cold temperatures may cause water droplets to form on its exterior and interior. To prevent this condensation, place the equipment in its carry case or a plastic bag before exposing it in a rapid temperature change.

- **Do not drop**

Strong shock or vibrations by dropping could cause malfunctions. Keep the strap around your wrist when carrying the camera.

- **Do not unplug or remove the battery when the camera is processing data**

When image data is being recorded or deleted from memory cards, cutting off the power could result in loss of data or damage to the internal circuitry or memory.

- **Handle the lens and all moving parts with care**

Do not touch the lens and lens barrel. Be careful when handling the memory card and battery. These parts are not designed for excessive handling.

- **Battery**

In low temperatures, the battery's capacity may decrease significantly due to the inactive chemical reaction. When taking pictures in cold weather, keep a warm backup battery on hand.

If the battery terminals get dirt or contamination on them, wipe them off with a dry, clean cloth or use an eraser to remove the stain.

- **Memory cards**

Turn off the power before inserting or removing the memory card.

Otherwise, the memory card could become unstable.

Memory cards may get hot during use, remove the memory card from the camera with care.



Digital Camera  
MD 85060  
FCC Tested To Comply  
With FCC Standards  
FOR HOME OR OFFICE USE

This mark on your camera certifies that this camera meets the requirements of the EU (European Union) concerning interference causing equipment regulations. CE stands for Conformité Européenne (European Conformity).

This device complies with Part 15 of the FCC Rules. Operation is subject to the following two conditions: (1) This device may not cause harmful interference, and (2) this device must accept any interference received, including interference that may cause undesired operation.

This Class B digital apparatus complies with Canadian ICES-003.

Do not remove the ferrite cores from the cables.

# Quick Start

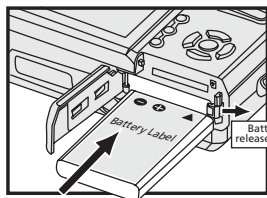

- 1 Insert the Li-ion battery see page 16.

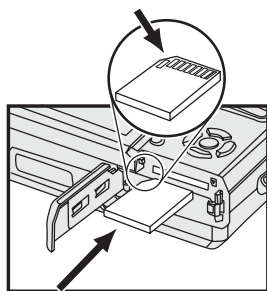

- 2 Insert the SD card. See page 16.

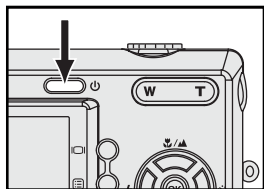

- 3 Turn on the camera. See page 18.

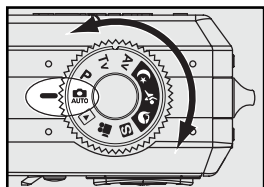

- 4 Rotate the mode dial to  and frame your subjects with the viewfinder or the LCD monitor.

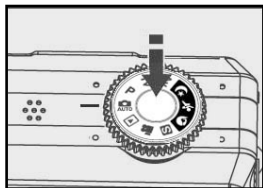

5 Slightly press the shutter release button half-way down and hold it to set the focus and exposure.



6 Press the shutter release button all the way down to take the picture.

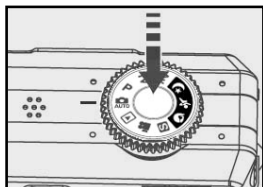

# Chapter 1





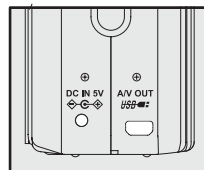
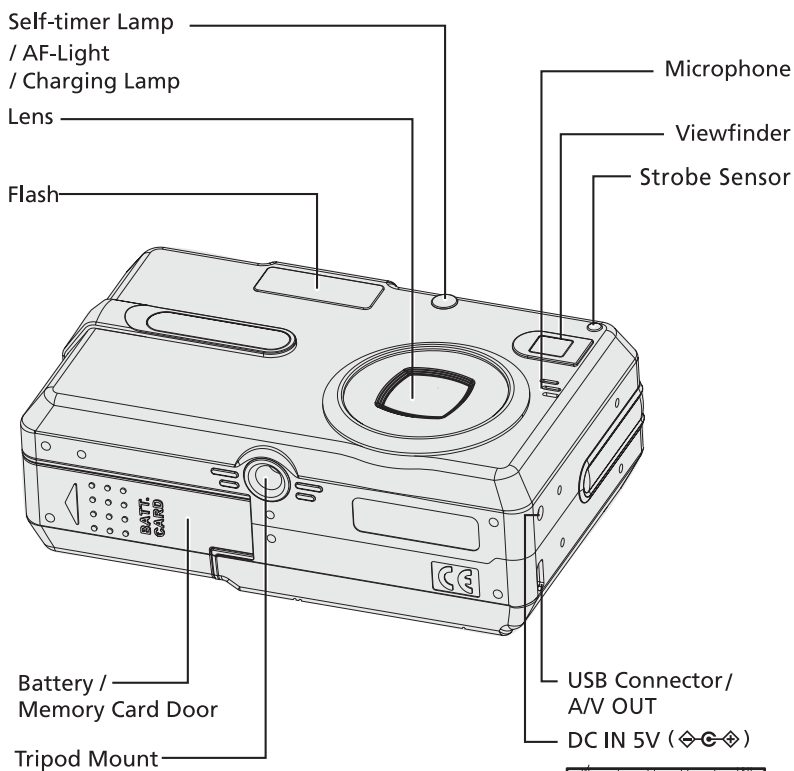

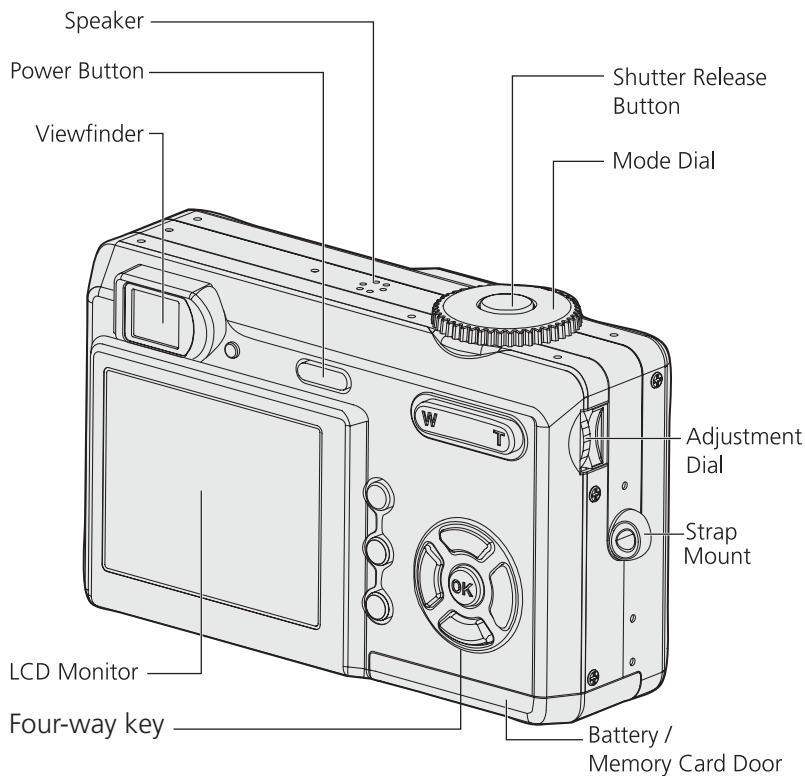
## Getting Started

### Camera Parts





## Mode Dial

	<b>Auto mode</b>		<b>Sports mode</b>
	<b>Playback mode</b>		<b>Night scene mode</b>
	<b>Movie mode</b>	<b>Av</b>	<b>AV(Aperture priority)</b>
	<b>Set Up mode</b>	<b>Tv</b>	<b>TV(Shutter Speed priority)</b>
	<b>Portrait mode</b>	<b>P</b>	<b>Program mode</b>

## Chapter 1: Getting Started

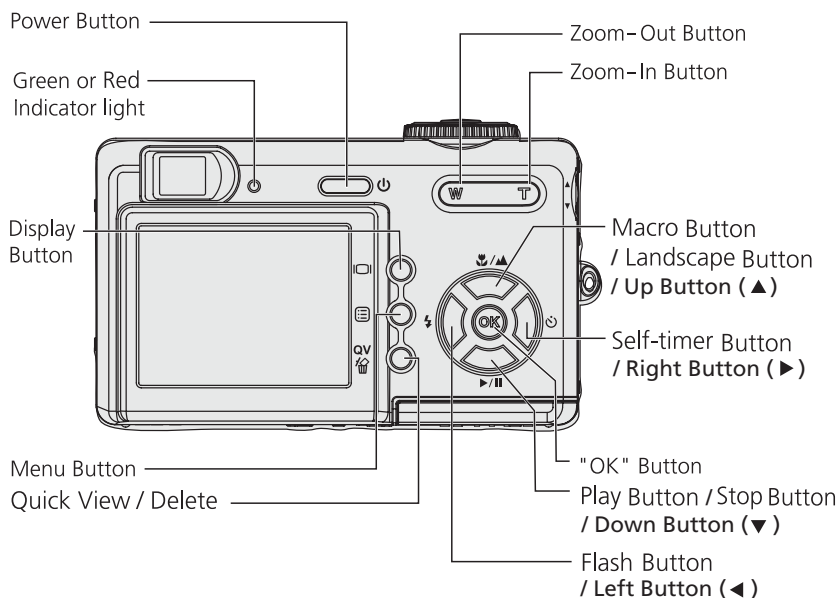

Green indicator light	Status
On	<ul style="list-style-type: none"> <li>Focus completed</li> <li>Connecting USB (The light is off automatically when USB is disconnected)</li> </ul>
Blinking	<ul style="list-style-type: none"> <li>The power is turning on (The light will be off after the camera is turned on)</li> <li>Saving file (The light will be off after file saved)</li> </ul>
Red indicator light	Status
On	<ul style="list-style-type: none"> <li>Movie recording</li> </ul>
Blinking	<ul style="list-style-type: none"> <li>System failure</li> <li>Flash is charging</li> </ul>



## **Set Up**

### ■ **Attaching the Wrist Strap**

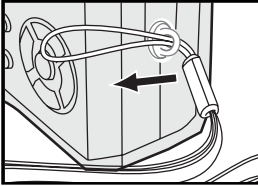

- 1** Thread the tip of the wrist strap-through the eyelet of the strap mount.

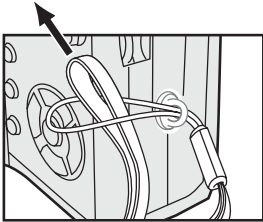

- 2** Loop the wrist strap as shown, and tighten the wrist strap to the strap mount.

### ■ Inserting the Battery

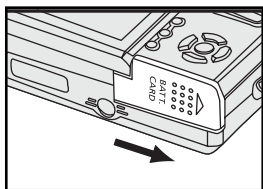

1 Slide the battery / memory card door in the arrow direction to open it.

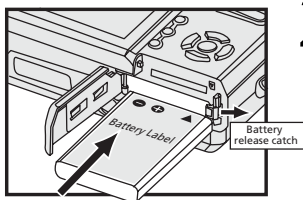

2 Insert the supplied Li-ion battery.

*Note : Hold the battery so that the label of the battery is on the top (observe the polarity!). Insert the battery; you will hear the catch snap in place. To remove the battery, push the red catch slightly to the right.*

### Loading the Battery

The battery must be fully charged before you can operate the camera (appr. 10 hours before first use).

To charge the battery, connect the supplied AC adaptor to the DC IN 5V socket (cf. page 17). Connect the other end of the AC adaptor to the power socket. The camera must be turned off.

The battery is now being charged. The indicator light on the front of the camera will light red. Before first use, leave the battery to charge for appr. 10 hours. When the indicator light is out, the battery is fully charged.

During normal use, a message "please load battery" appears on the display when the battery is flat (the battery symbol is empty). Charge the battery again with the supplied adaptor. The charging time is now shorter.

The battery is equipped with an overcharge protection.

*Note: To conserve battery power, use the viewfinder, instead of the LCD monitor to take the picture. Also, you can also activate the power saving function to increase battery life.*

## ■ Inserting the memory card

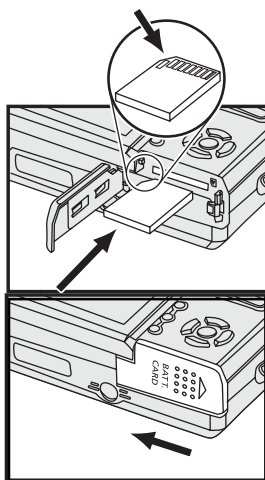



- 1 Open the battery/memory card door and insert the memory card (connectors facing upwards).
- 2 Close and slide the battery/memory card door in the arrow direction to fix it closed.

*Note : Be sure to close the battery / memory card door firmly otherwise, you might not be able to turn on the camera.*

## ■ Using the AC Adaptor

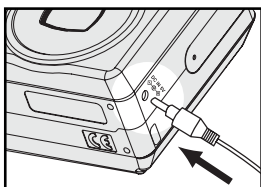
When reviewing pictures or operating the camera indoors, you can use the AC adaptor as a power source to save the battery power.



- 1 Connect the AC adaptor to  (the DC IN 5V ).

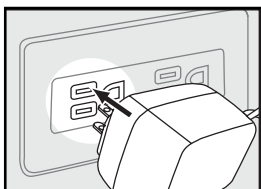

- 2 Connect the other end of the AC adaptor to the power socket.

*Note : Make sure to use only the AC adapter (5V) supplied with the camera. Damage caused by use of the incorrect adapter is not covered under the warranty.*



## ■ Setting the Language

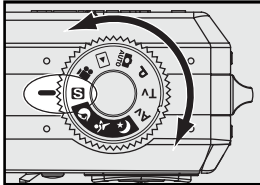

1 Rotate the mode dial to Set-Up "S".

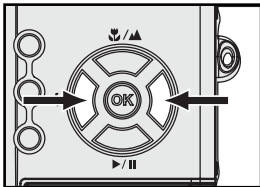

2 Scroll through the menu by using ◀▶ on the four-way key and move to "LANGUAGE".

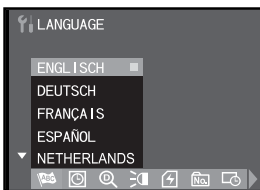

3 On the "LANGUAGE" submenu, press ▲▼ on the four-way key to select the language.

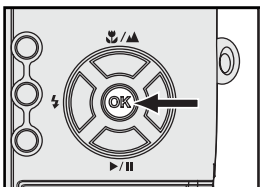

4 Press "OK" to confirm the language setting.

### ■ Setting the Date and Time

Set the date and time so that they appear correctly when you are reviewing the images with your camera.

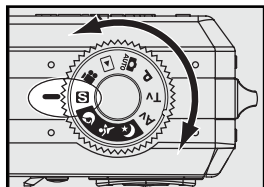

1 Rotate the mode dial to Set-Up "S".



2 Scroll through the menu by using ◀▶ on the four-way key and move to "CLOCK SET". Enter the submenu by pressing "OK" button on the four-way key.

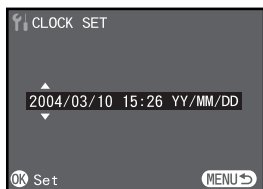

3 Press ◀ or ▶ to select Year, Month, Day, Hour and Minute. Press ▲ or ▼ buttons, you can increase or decrease the value.

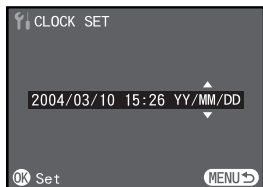

4 Press ◀ or ▶ to date display mode as shown. Press ▲ or ▼ to set the date display in YY/MM/DD (year/month/day), MM/DD/YY (month/day/year) or DD/MM/YY (day/month/year).

5 Press "OK" to confirm the setting.

## Chapter 2

# Taking Pictures and Recording Video Clips

### Using the LCD Display

When you turn the camera on, the LCD monitor turns on automatically. With the LCD monitor, you can frame images that you want to take or record as video clips. You can also view the menus of each mode. The following figures give you the information of the icons shown on the LCD monitor.

*Note 1 : You may not see the LCD display clearly when using the LCD monitor under intense light, such as sunlight. In this situation, you can position the subject by viewfinder.*

*Note 2 : You may turn off LCD display and use optical viewfinder to save the battery power for taking more pictures.*

*Note 3 : You may find that the shutter release button reacts slower than expected. This is not a malfunction of the camera.*

### ■ Still Mode

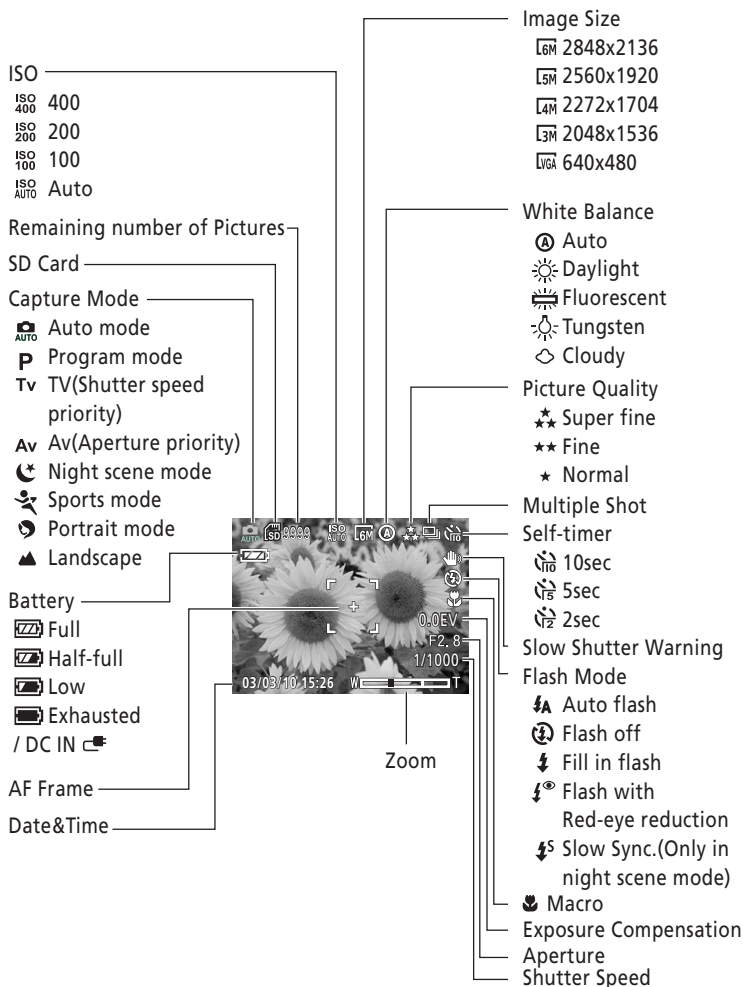



## ■ Movie Mode

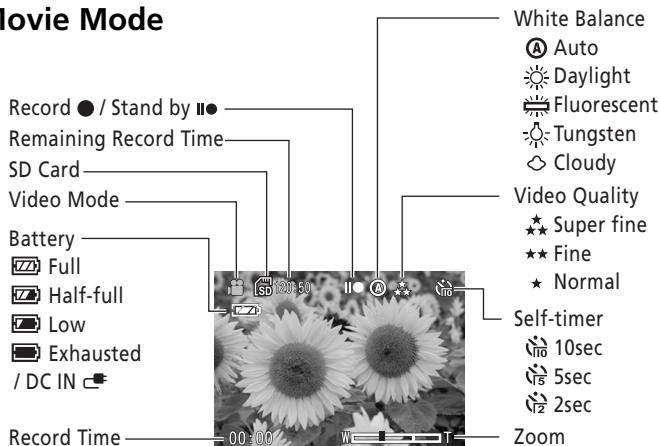

## ■ Changing the Contents on the LCD Monitor

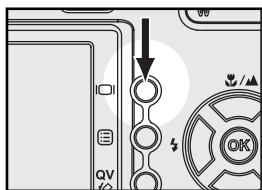

Press button in **AUTO**, **P**, **Tv**, **Av**, **M**, **S**, **B** or **▲** mode to change the LCD monitor display mode in the following order:



### Using Zoom

This camera provides you with 3x optical zoom and 7x digital zoom.

#### ■ Optical Zoom

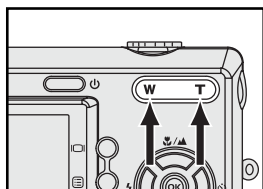

1 Press "W/T" buttons to zoom out and zoom in.

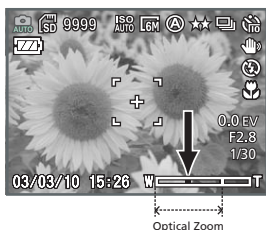

2 You can see the zoom in / out indicator on the LCD monitor. The optical zoom range is from 1.0x to 3.0x.

#### ■ Digital Zoom

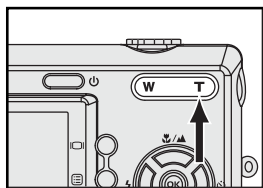

1 Press "T" button to Optical Zoom in to the maximum level (3X), release & press "T" button again to enter digital zoom mode.

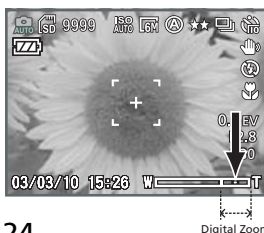

2 A green frame surrounds the area of the image to be captured.

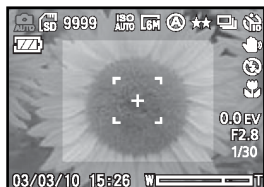

- 3 When the green frame is at the desired size, press Shutter button to take the picture.

*Note : Digital zoom reduces the resolution of an image, therefore, your picture will tend to be more pixilated then the same image taken with optical zoom.*

### Setting Digital Zoom

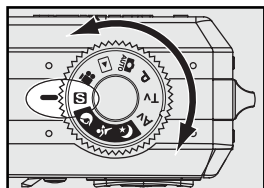

*Note : If "DIGITAL ZOOM" can not be used, you may check "DIGITAL ZOOM" on camera set up as below.*

- 1 Rotate the mode dial to Set-Up "S".

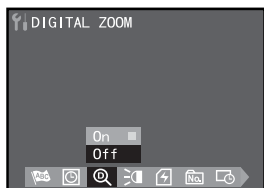

- 2 Scroll through the menu by using ◀▶ on the four-way key and move to "DIGITAL ZOOM".

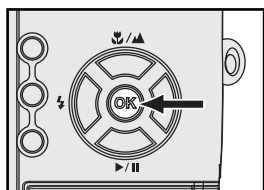

- 3 Move the submenu to the icon "on", then the press "OK" button.

### Taking Still Pictures

#### ■ Using Auto Focus

Press the shutter release button halfway down to set the focus and exposure. The camera will automatically focus on the subject in the centre of the frame.

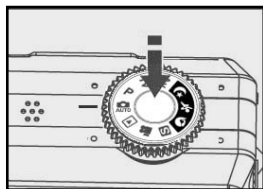

- 1 Frame your subject with the viewfinder or the LCD monitor. Slightly press the shutter release button halfway down and hold it to set the focus and exposure.



- 2 You will hear a sound, and indicator light when the auto focus is set.

*Note : Different colours of focus brackets stand for different focus condition.*

AF success	When colour of focus bracket is changed from "white" to "green".
AF fail	When colour of focus bracket is changed from "white" to "red" .

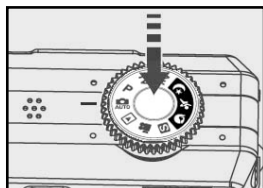

- 3 Press the shutter release button all the way down to take the picture.

*Note: Auto focus might fail in some circumstance:*

- \* When you shoot behind a sheet of glass.
- \* When you shoot subjects that have low contrast in colour (eg: sky, white walls and so on).
- \* When there is a long distance between two subjects in the same frame (the camera might be misled to focus on the wrong subject).
- \* When there is only horizontal lines in the frame.

### ■ Using Focus Lock

If your subject is not in the centre of the frame, the picture may be out of focus when you press the shutter release button halfway down. Focus lock allows you to focus on an off-centre subject.



- 1 Frame your subjects in the centre of the frame with the viewfinder or the LCD monitor. Slightly press the shutter release button halfway down and hold it to set the focus and exposure.



- 2 Keep pressing the shutter release button halfway down and recompose your picture.

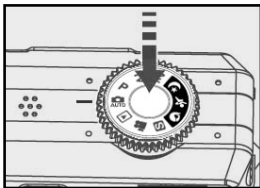

- 3 Press the shutter release button all the way down to take the picture.



*Note : Different colours of focus brackets stand for different focus condition.*

AF success	When colour of focus bracket is changed from "white" to "green".
AF fail	When colour of focus bracket is changed from "white" to "red" .

### ■ Macro Mode (🌸)

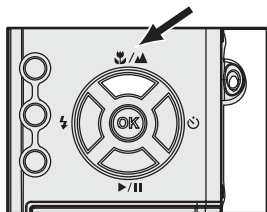

1 The Macro is used for shooting close-up pictures and getting the detail and sharpness of the subject.

2 Select macro mode by pressing "▲" button. Check the Macro mode icon "🌸" is show on the LCD monitor.

3 Frame your subject, press shutter release button to take pictures.

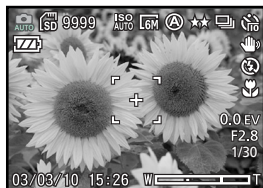

## Capture Mode

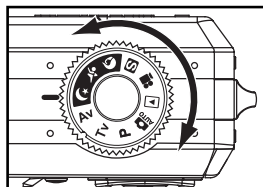

According to different shooting situations, the camera provides you with eight capture modes. You could have four scene modes on / / / / and other modes on / **P** / **Tv** / **Av**.



### ■ Night scene ()

Allows you to shoot night scenes at far distance without losing the dark atmosphere of the surroundings. The shutter speed becomes slower, therefore, we recommend using a tripod to prevent shaking.

*Note1 : In night scene mode, you can use slow synchro (P.36), it is a flash mode that allows you to take pictures of people at night that clearly show both your subjects and the night time backdrop.*

*Note2: When appears on the LCD monitor, we recommend you to use a tripod to avoid taking blurry pictures caused by hand shake.*



### ■ Sports ()

Use this mode to shoot moving subjects outdoors or in bright places.

This setting uses high shutter speeds to capture the action of fast-moving subjects.

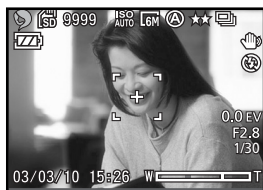

### ■ Portrait (👤)

Used for shooting portraits.

This setting uses a larger aperture to reduce depth-of-field, and brings the subject into focus while blurring the background and enhancing flesh tones.

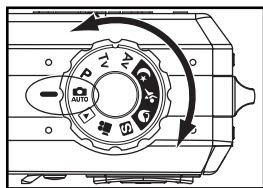

### ■ Landscape (▲)

If the subject is far from the camera, use the landscape mode

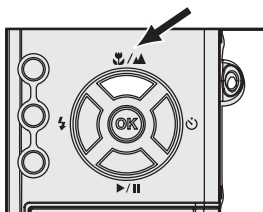

- 1 Rotate the mode dial to "  ".



- 2 Select landscape mode by pressing "  " button on the four-way key.  will appear on the left-top of screen when Landscape Mode is entered.



- 3 Frame your subject with the viewfinder or the LCD monitor. Press shutter release button to take picture.



## ■ Setting Shutter Speed Priority

In this mode, pictures are taken with the priority given to shutter speed. The camera sets the aperture value automatically.

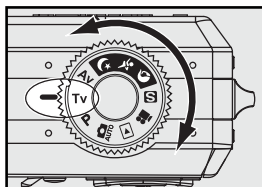

- 1 Rotate the mode dial to Shutter Speed Priority " Tv ".

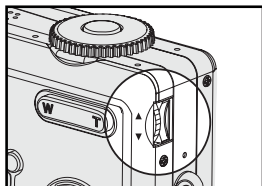

- 2 Rolling "Adjustment Dial" ▲▼ to set the shutter speed (2.0sec~ 1/2000sec) and the camera sets the aperture value automatically.



- 3 If you want to adjust the EV value, press ▼ on the four-way (EV value will be selected and light red) and then roll the "Adjustment Dial" to adjust EV value.



- 4 Frame your subject with the viewfinder or the LCD monitor. Slightly press the shutter release button halfway down and then press the shutter release button all the way down to take the picture.

*Note: When  appears on the LCD monitor, we recommend you use a tripod to avoid taking blurry pictures caused by hand shake.*

### ■ Setting Aperture Priority

In this mode, pictures are taken with the priority given to aperture value. The camera sets the shutter speed automatically.

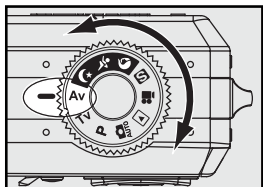

- 1 Rotate the mode dial to Aperture Value Priority "Av".

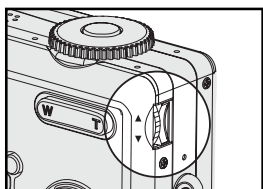

- 2 Rolling "Adjustment Dial" ▲▼ to set the aperture value and the camera sets the shutter speed automatically.



- 3 If you want to adjust the EV value, press ▼ on the four-way key (EV value will be selected and light red) and then roll the "Adjustment Dial" to adjust EV value.



- 4 Frame your subject with the viewfinder or the LCD monitor. Slightly press the shutter release button halfway down and then press the shutter release button all the way down to take the picture.

*Note1 : Aperture value when zoom-out(W):  
f2.8 , f5.2 , f7.1*

*Note2 : Aperture value when zoom-in(T):  
f4.9 , f8.9 , f12.2*

*Note3 : When  appears on the LCD monitor, we recommend you use a tripod to avoid taking blurry pictures caused by hand shake.*

## ■ Setting Program Mode

This camera automatically adjusts three sets of shutter speed and aperture values. The advantage of program mode in comparison with Auto Mode is that you can choose one of these three sets.

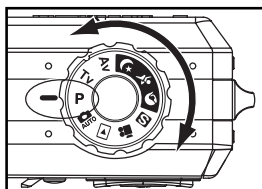

- 1 Rotate the mode dial to Program mode " P ".

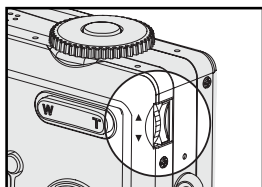

- 2 Rolling "Adjustment Dial" ▲▼ to choose one set of shutter speed and aperture values.



- 3 If you want to adjust the EV value, press ▼ on the four-way key (EV value will be selected and light red) and then roll the "Adjustment Dial" to adjust EV value.



- 4 Frame your subject with the viewfinder or the LCD monitor. Slightly press the shutter release button halfway down and hold it to set the focus and exposure.

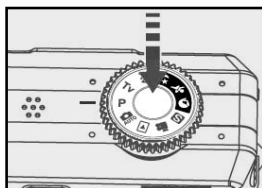

- 5 Press the shutter release button all the way down to take the picture.

### ■ Setting Exposure Compensation

Under some conditions, the automatic exposure may be misled into using the wrong readings. Exposure compensation allows you to adjust the exposure value and correct the exposure time when taking pictures.

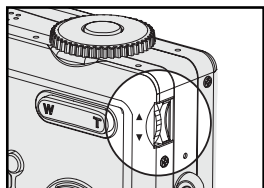

1 In , , or mode, Rolling "Adjustment Dial" .



2 Use adjustment dial to adjust the exposure value (from -2.0 ~ +2.0).

*Note 1: EV setting goes back to default (0.0 EV) after you turn off the camera.*

*Note 2: Only on the following capture modes , you can setting EV : , **P** , **Tv** , **Av** , , or .*

*Note 3: If you want to adjust the EV value in **P** , **Tv** , **Av** mode, Press on the four-way key (EV value will be selected and light red) and then roll the "Adjustment Dial".*

## ■ Using Self-timer

Self-timer function allows you to take pictures 2 sec, 5 sec or 10 sec after you press the shutter release button all the way down. When you want to include yourself into the picture, but can find no one to take the picture for you, you can use this convenient function. We recommend you use a tripod or place the camera on a steady surface when using self-timer.

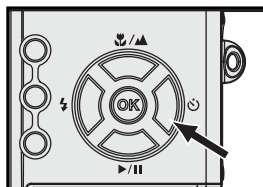

- 1 Press the four-way key ► self-time icon  will appear on the right-upper side of LCD monitor.

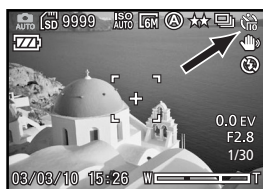

- 2 You can press ► on the four-way key to switch self-timer modes: 2 sec, 5 sec , 10 sec or turn off the self-timer.

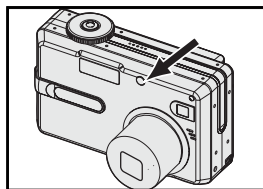

- 3 After locking the focus and pressing the shutter release button all the way down, the self-timer lamp blinks slowly first then quick before capture.

### ■ Using Built-in Flash

When taking pictures in a difficult lighting condition, you may need the flash to obtain the correct exposure. The camera provides you with four built-in flash modes. Switch through the flash modes in by using ◀ on the four-way key.

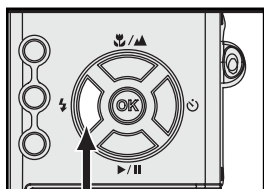

Mode	Function
⚡ Auto Flash	Flashlight fires automatically when the lighting condition is dark.
⚡👁 Red-eye Reduction	Reduces the "red-eye" effect resulting from the flash.
⚡ Fill in Flash	Flashlight fires whenever you take a shot, regardless of the lighting condition.
🔕 Flash Off	Flash is turned off.
⚡S Slow Sync.	Flash fires with slow shutter speed to get natural exposure.
* Only in night scene mode "🌙".	

## **Recording Video Clips**

Movie mode allows you to record video clips.

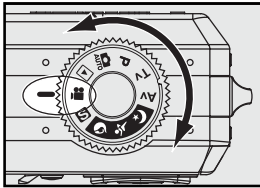

**1** Rotate the mode dial to Movie Mode "  " .

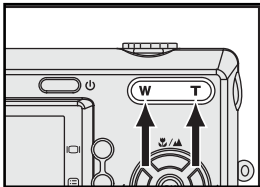

**2** Frame your subjects by using "W/T" .

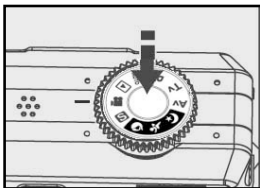

**3** Slightly press the shutter release button half way down and hold it to set the focus and exposure.



**4** Press the shutter release button all the way down to start recording.





**5** Press ▼ on the four-way key to pause.  
Press ▼ button on the four-way key again to continue recording video clips.

**6** Press the shutter release button again to stop recording.

### ■ Setting White Balance

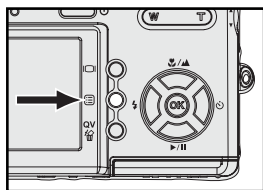
White Balance allows you to correct colour shifts resulting from different lighting conditions when shooting video.



1 Turn the mode to "  " .

2 Press Menu button "  " to enter the video menu.

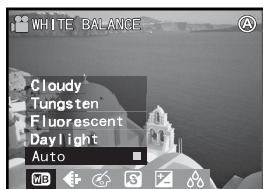



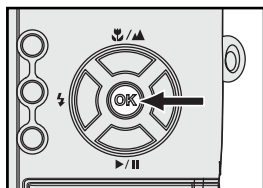

3 Press ◀▶ on the four-way key, to select WHITE BALANCE "  " .

4 Press ▲▼ on the four-way key to select "Cloudy", "Tungsten", "Fluorescent", "Daylight" or "Auto".



5 Press "OK" to confirm the setting.  
Press Menu button back to video capture.

Mode	Function
 Cloudy	Setting for shooting in overcast condition.
 Tungsten	Setting for shooting in incandescent or halogen condition.
 Fluorescent	Setting for shooting in fluorescent condition.
 Daylight	Setting for shooting in daylight condition.
 Auto	The camera will automatically adjust the setting according to the lighting condition.



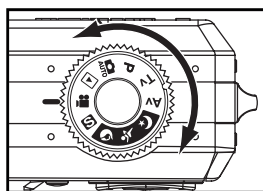

## ■ Setting Video Quality

In order to reduce the size of the files and have more memory storage space, files are compressed. However, compression leads to the loss of image quality. In other words, the less you compress the file, the better the quality is, and the more memory space it requires. Video size (resolution) determines the detail of the video.

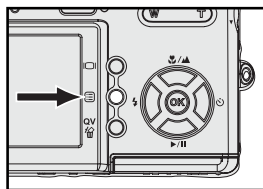

1 Turn the mode to "  " .



2 Press Menu button "  " to enter the video menu.



3 Press ◀▶ on the four-way key to select VIDEO QUALITY "  " .

4 Press ▲▼ on the four-way key to select "Super Fine", "Fine" or "Normal".

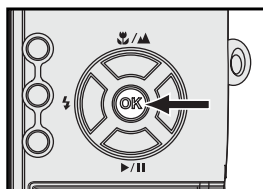



5 Press "OK" to confirm the setting.  
Press Menu button back to video capture.

### ■ Setting Video Effect

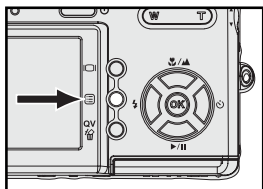
This mode allows you to have special effects on the video clips.



1 Turn the mode to "  " .

2 Press Menu button "  " to enter the capture menu.



3 Press ◀▶ on the four-way key to select VIDEO EFFECT "  " .

4 Press ▲▼ on the four-way key to select "B&W" (Black & White), "Sepia" or "Normal" .

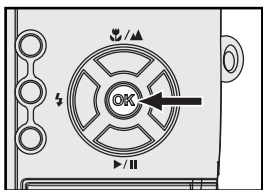

5 Press "OK" to confirm the setting.  
Press Menu button back to video capture.

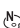
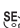
Mode	Function
 B&W (Black &White)	Produces black & white video clips.
 Sepia	Makes the video clips look like vintage film. (reddish-brown)
 Normal	No special effect.

## ■ Setting Sharpness

Adjusting settings of sharpness allows you to emphasise or soften the edges of the image.

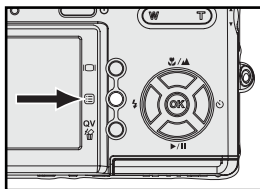

1 Turn the mode to "📷".

2 Press Menu button "☰" to enter the video menu.



3 Press ◀▶ on the four-way key to select SHARPNESS "S".

4 Press ▲▼ on the four-way key to select "High", "Medium" or "Low".

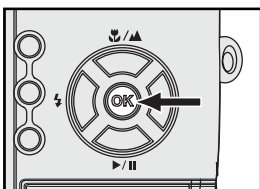



5 Press "OK" to confirm the setting.  
Press Menu button back to video capture.

Mode	Function
High	Emphasises the outline. If you want your subjects (such as buildings) to have a clear and sharp outline, we suggest you use this mode.
Medium	Suitable for ordinary shots.
Low	Softens the outline. If you want your subjects (such as people) to have a soft outline, we recommend you use this mode.

### ■ Setting Contrast

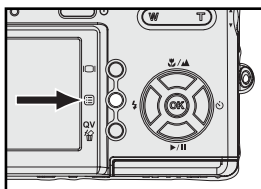
Adjusting settings of contrast allows you to harden or soften the image.



1 Turn the mode to "  " .

2 Press Menu button "  " to enter the capture menu.



3 Press ◀▶ on the four-way key to select CONTRAST "  " .

4 Press ▲▼ on the four-way key to select "Hard", "Normal" or "Soft".

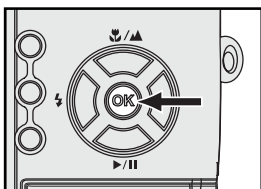



5 Press "OK" to confirm the setting.  
Press Menu button back to video capture.

Mode	Function
Hard	If you want your images to look brighter, we recommend you use this mode.
Normal	Suitable for ordinary shots.
Soft	If you want your images to look softer, we suggest you use this mode.

## ■ Setting Saturation

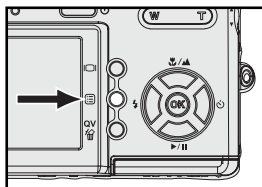
Saturation is the intensity and purity of colour. This option allows you to adjust images to make them look more vivid or dull.



1 Turn the mode to "  ".

2 Press Menu button "  " to enter the capture menu.



3 Press ◀▶ on the four-way key to select SATURATION "  ".

4 Press ▲▼ on the four-way key to select "More", "Normal" or "Less".

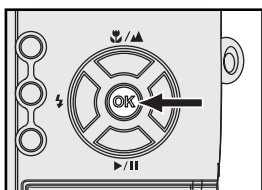

5 Press "OK" to confirm the setting.  
Press Menu button back to video capture.

Mode	Function
More	Make image more vivid. If you want your image to look more vivid, we recommend that you use this mode.
Normal	Suitable for ordinary shots.
Less	Make image more dull. If you want your image to look gray, we suggest you to use this mode.

### Using the Capture Menu

Options in the capture menu allow you to adjust settings for picture taking.

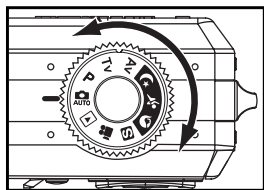

- 1 Turn the mode to AUTO , **P** , Tv , Av , , , or .

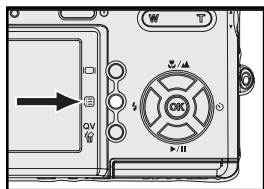

- 2 Press Menu button " " to enter the capture menu.



- 3 Scroll through the menu and by using the four-way key .

- 4 Press on the four-way key to select the setting of each submenu item.

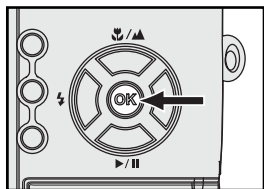

- 5 Press "OK" to confirm the setting.  
Press Menu button back to still capture.

## ■ Setting White Balance

White Balance allows you to correct colour shifts resulting from different lighting conditions when taking pictures.

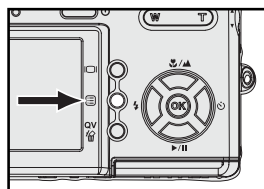

1 Turn the mode to , **P** , **Tv** , **Av** , , , or .

2 Press Menu button " " to enter the capture menu.



3 Press on the four-way key to select WHITE BALANCE " ".

4 Press on the four-way key to select "Cloudy", "Tungsten", "Fluorescent", "Daylight" or "Auto".

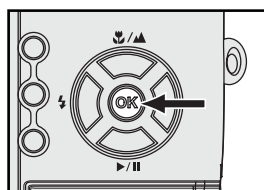

5 Press "OK" to confirm the setting.  
Press Menu button back to still capture.

Mode	Function
Cloudy	Setting for shooting in overcast condition.
Tungsten	Setting for shooting in incandescent or halogen condition.
Fluorescent	Setting for shooting in fluorescent condition
Daylight	Setting for shooting in daylight condition.
Auto	The camera will automatically adjust the setting according to the lighting condition.

### ■ Setting ISO (Sensitivity)

ISO value affects the camera's sensitivity to light. The default ISO setting is "Auto", but you can also adjust the setting manually. Use low ISO value in bright conditions, and high ISO value when light is insufficient.

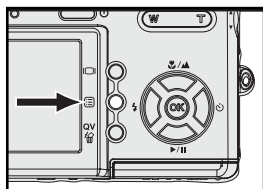

1 Turn the mode to **P**, **Tv**, **Av**, **M**, **S**, or **mountain icon**.

2 Press Menu button "☰" to enter the capture menu.



3 Press **◀▶** on the four-way key to select ISO "ISO".

4 Press **▲▼** on the four-way key to select "Auto", "ISO 100", "ISO 200" or "ISO 400".

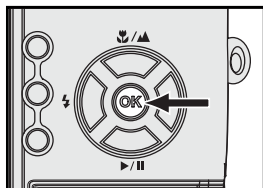

5 Press "OK" to confirm the setting.  
Press Menu button back to still capture.

*Note 1: High ISO value may lead to noise in the picture.*

*Note 2: ISO speed will be reset to default "Auto" after you turn off the camera.*



## ■ Setting Image Size (Resolution)

With this function, you can choose which image size (the number of pixels) to store your pictures on the memory card. This camera provides you with five different image sizes. You will have more detailed images with high resolutions but the file size will be larger.

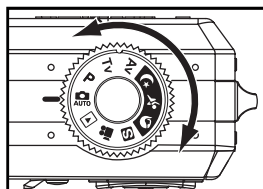

- 1 Turn the mode to , **P** , **Tv** , **Av** , , , or .

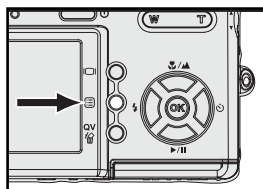

- 2 Press Menu button " " to enter the capture menu.



- 3 Press on the four-way key, to select IMAGE SIZE " ".

- 4 Press on the four-way key to select "2848x2136 (6M)", "2560x1920 (5M)", "2272x1704 (4M)", "2048x1536 (3M)" or "640x480 (VGA)"

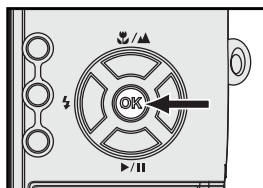

- 5 Press "OK" to confirm the setting.  
Press Menu button back to still capture.

### ■ Setting Picture Quality

In order to reduce the size of the files and to have more memory storage space, files are compressed. However, compression leads to the loss of image quality. In other words, the less you compress the file, the better the quality is, and the more memory space you require. Image size (resolution) determines the detail of the image.

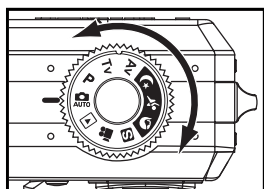



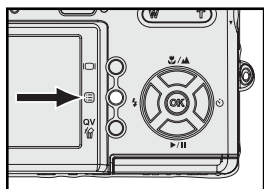

- 1 Turn the mode to **AUTO** , **P** , **Tv** , **Av** ,  ,  ,  or  .



- 2 Press Menu button "  " to enter the capture menu.



- 3 Press   on the four-way key to select PICTURE QUALITY "  ".

- 4 Press   on the four-way key to select "Super Fine", "Fine" or "Normal".

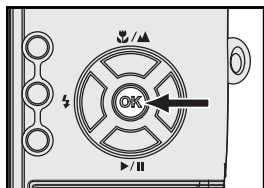

- 5 Press "OK" to confirm the setting.  
Press Menu button back to still capture.

## ■ Setting Picture Effect

This mode allows you to have special effects on the pictures.

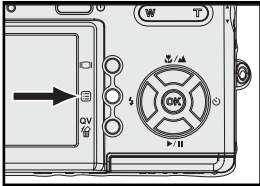

1 Turn the mode to , **P** , **Tv** , **Av** , , , or .

2 Press Menu button " " to enter the capture menu.



3 Press on the four-way key to select PICTURE EFFECT " ".

4 Press on the four-way key to select "B&W" (Black & White), "Sepia" or "Normal".

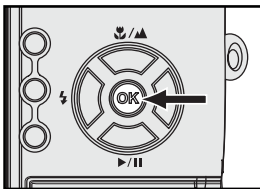

5 Press "OK" to confirm the setting.  
Press Menu button back to still capture.

Mode	Function
B&W (Black & White)	Produces black & white photos.
Sepia	Makes the pictures look like vintage pictures (reddish-brown).
Normal	No special effect.

### ■ Setting Sharpness

Adjusting settings of sharpness allows you to emphasise or soften the edges of the image.

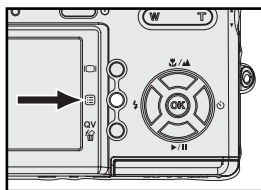

1 Turn the mode to , **P** , **Tv** , **Av** , , , or .

2 Press Menu button " " to enter the capture menu.



3 Press on the four-way key to select SHARPNESS " " .

4 Press on the four-way key to select "High", "Medium" or "Low".

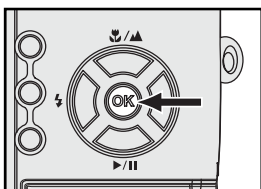

5 Press "OK" to confirm the setting.  
Press Menu button back to still capture.

Mode	Function
High	Emphasises the outlines. If you want your subjects (such as buildings) to have a clear and sharp outline, we suggest you use this mode.
Medium	Suitable for ordinary shots.
Low	Softens the outlines. If you want your subjects (such as people) to have a soft outline, we recommend you use this mode.

## ■ Setting Contrast

Adjusting settings of contrast allows you to harden or soften the image.

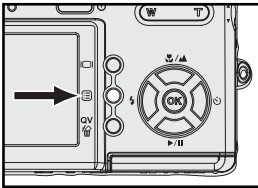

1 Turn the mode to , **P** , **Tv** , **Av** , , , or .

2 Press Menu button " " to enter the capture menu.

3 Press on the four-way key to select CONTRAST " ".



4 Press on the four-way key to select "Hard", "Normal" or "Soft".

5 Press "OK" to confirm the setting. Press Menu button back to still capture.

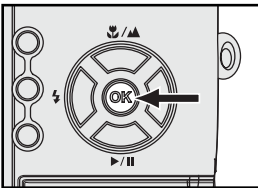

Mode	Function
Hard	Make contrast of brightness stronger. If you want your images to look brighter, we recommend you use this mode.
Normal	Suitable for ordinary shots.
Soft	If you want your images to look softer, we suggest you use this mode.

### ■ Setting Saturation

Saturation is the intensity and purity of colour. This option allows you to adjust images to make them look more vivid or dull.

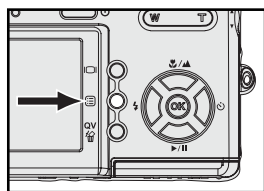

1 Turn the mode to , **P** , **TV** , **Av** , , , or .

2 Press Menu button " " to enter the capture menu.

3 Press on the four-way key to select SATURATION " ".

4 Press on the four-way key to select "More", "Normal" or "Less".



5 Press "OK" to confirm the setting.  
Press Menu button back to still capture.

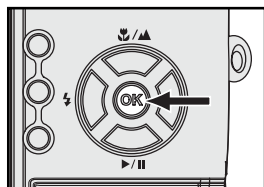

Mode	Function
More	Make image more vivid. If you want your image to look more vivid, we recommend that you use this mode.
Normal	Suitable for ordinary shots.
Less	Make image more dull. If you want your image to look gray, we suggest that you use this mode.

## ■ Setting Exposure Area

Measure the Exposure Value from the centre area of the whole picture. You can use this mode to target the object you are interested in.

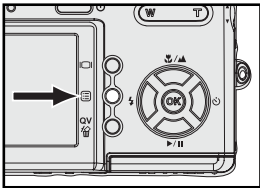

1 Turn the mode to , **P** , **Tv** , **Av** , , , or .

2 Press Menu button " " to enter the capture menu.



3 Press on the four-way key to select EXPOSURE AREA " ".

4 Press on the four-way key to select "Full" or "Central"

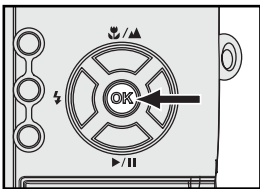

5 Press "OK" to confirm the setting.  
Press Menu button back to still capture.

Mode	Function
Full	Measure the Exposure Value from the whole picture area. You can use this mode in most cases.
Central	Measure the Exposure Value from the centre of the whole picture area. The centre area is about 1/4 of image area.

### ■ Taking Multiple Shot

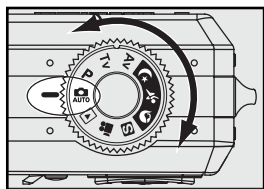

When setting the capture mode to "Single", you can capture a single picture each time you press the shutter release button all the way down. If you want to shoot images of moving events, you can activate "Continues" to gain a series of pictures.





1 Turn the mode to  , **P** , **Tv** , **Av** ,  ,  ,  ,  
 or .

2 Press Menu button "  " to enter the capture menu.



3 Press   on the four-way key to select MULTIPLE SHOT "  " .

4 Press   on the four-way key to select "Single " or "Continuous " .

5 Press "OK" to confirm the setting.  
Press Menu button back to still capture.

Image Size	Continuous Number of Pictures
2848 x 2136 (6M)	2
2560 x 1920 (5M)	2
2272 x 1704 (4M)	3
2048 x 1536 (3M)	3
640 x480 (VGA)	3



# Chapter 3

## Playback Images and Video Clips

### Using the LCD Display

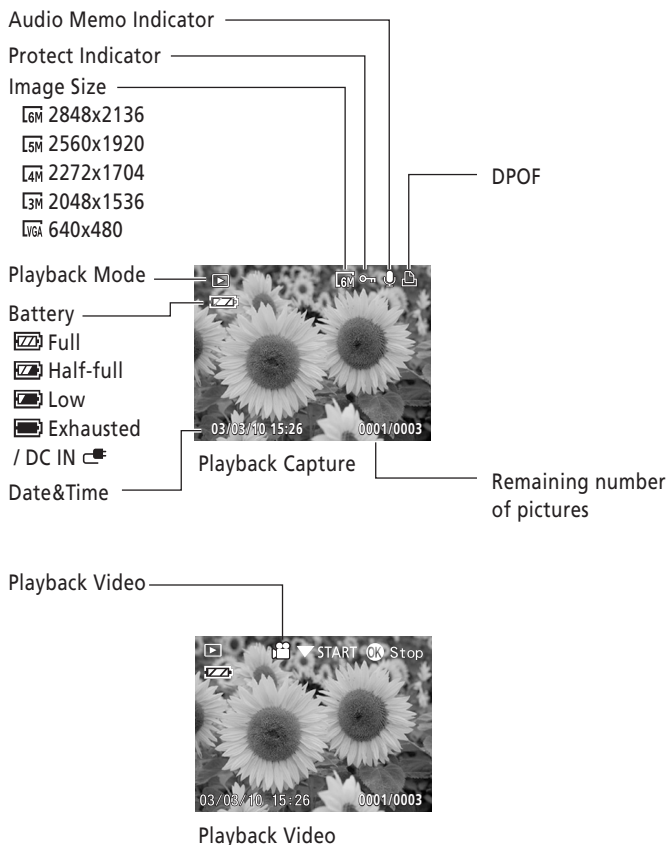

## Using Playback

Playback mode allows you to review your still images and video clips.

### ■ Viewing Still Images

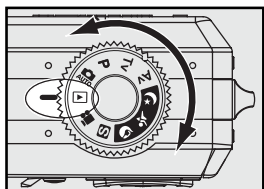

- 1 Rotate the mode dial to Playback mode "▶".

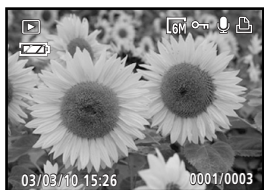

- 2 The last still picture you took and the information of that picture appears on the LCD monitor.

If your last shot is a video clip, the first frame (image) will be displayed on the LCD monitor.



- 3 Press "W" button get into thumbnail display mode, then use ◀, ▶, ▲ and ▼ on the four-way key to select the file.

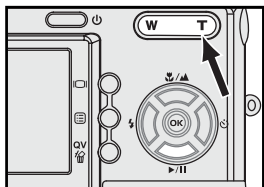

- 4 Press "OK" or "T" button to display the selected image at its normal size.

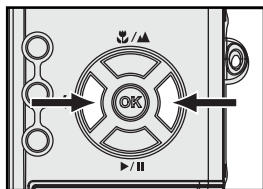

- 5 Use ◀ and ▶ on the four-way key to display the previous or next image.

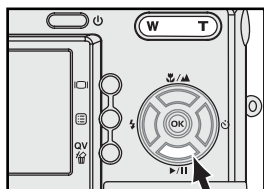

- 6 When you select a video clips, use ▼ on the four-way key to play or pause video.



- 7 Press "OK" to stop video.

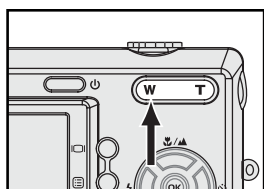

- 8 Press "W" button to return to thumbnail display mode.

### ■ Activating Digital Enlargement

You can magnify pictures you have taken for a closer viewing on the LCD monitor. This feature is useful for checking the focus or fine details.



- 1 Press "T" or "OK" button enter single image display mode, then press "T" button to zoom in, press "W" button to zoom out, and navigate the enlarged image by using ◀, ▶, ▲, ▼ and ▾ on the four-way key.

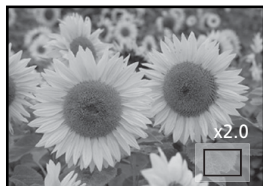

- 2 On the LCD monitor, you will see the navigation icon and scale as shown. (max. zoom scale : x6.0)

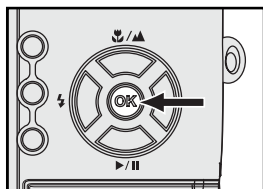

- 3 Press "OK" to return to the original image size.

## Using the Playback Menu

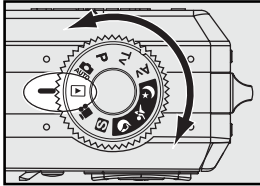

1 Rotate the mode dial to Playback "▶".

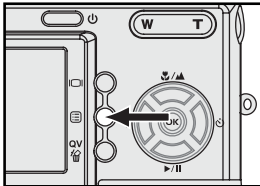

2 Press Menu button "☰".



3 Use ◀▶ on the four-way key to scroll through the menu, and press ▲▼ on the four-way key to scroll through the submenu.

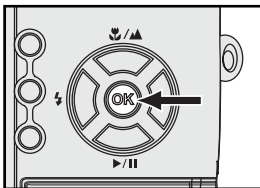

4 Press "OK" to confirm the setting.

5 After finishing the setting, press Menu button "☰" again to exit.

### ■ Deleting Images

This function allows you to delete still images and/or video clips.



- 1 Rotate the mode dial to Playback mode "▶". Press menu button. In the playback menu, press ◀ or ▶ to select DELETE "🗑".

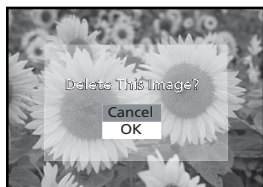

- 2 Press ▲ or ▼ to select "One", "All" or "Select".

- 3 A confirmation dialog will be displayed. Press ▲ or ▼ to select "OK" and press "OK" button to delete one or all Images.

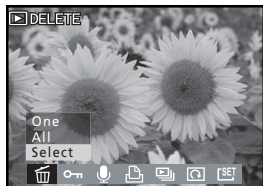

- 4 To decide which images to delete, choose "Select" and then press "OK" button.



- 5 Use ◀, ▲, ▶ and ▼ on the four-way key to select picture. Press "OK" button to mark pictures to delete. Press Menu button to next step.

*Note : If the file is under protection, you have to remove the protection first and then delete it.*

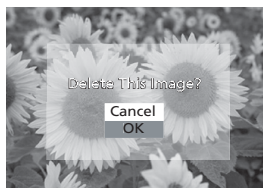

- 6 Press ▲ or ▼ to select "OK". Press "OK" button to delete pictures.

## ■ Protecting Pictures and Video Clips

Protect function prevents pictures and/or video clips from being modified or deleted.



- 1 Rotate the mode dial to Playback mode "▶". Press menu button. In the playback menu, press ◀ or ▶ to select PROTECT "🔑".



- 2 Select "One" and press "OK" to Set / Cancel the protection the file which display on the monitor.
- 3 Select "All" and press "OK" to Set / Cancel all of the protection .



- 4 Choosing "Select" and then pressing "OK" allows you to protect the files you choose. Use ◀, ▲, ▶ and ▼ on the four-way key to select files and press "OK" to Set/Cancel the protection.



*Note 1: 🔑 appears on the LCD monitor when you protect the picture.*

*Note 2: All of the images, including the protected ones, are deleted when you format the memory card.*

### ■ Recording Audio Clips for Still Images

You can record an audio memo for each still picture.



- 1 Rotate the mode dial to Playback mode "▶". Press menu button. In the playback menu, press ◀ or ▶ to select MEMO "🎤".



- 2 To record an audio memo, select "Record" in the submenu and then press "OK". Press ▼ on the four-way key to start or stop recording. Press "Menu" button to return playback mode.



- 3 To playback an audio memo select "Play" in the submenu, then press "OK". Press ▼ on the four-way key to start or stop the playback memo. Finally press "Menu" button to return to playback mode.







**4** To delete a memo, select "Delete".

*Note 1:  appears on the LCD monitor when you memo the picture.*

*Note 2: All of the images, including the ones with memos, are deleted when you format the memory card*

## ■ Setting DPOF (Digital Print Order Format)

The DPOF function helps you to print out your pictures directly through certain photo printers, without connecting the camera to a computer.



**1** In the playback menu, select DPOF "  ".

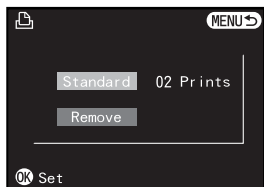

**2** To decide which picture to print and the number of copies, select "Standard" and then press "OK".



- 3 Use ◀▶ on the four-way key to select the pictures and ▲▼ on the four-way key to adjust the numbers of copies.



- 4 To print index of pictures, select "Index" and press "OK" on the four-way key.

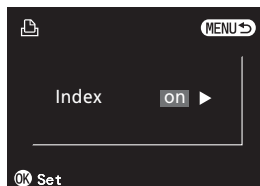

- 5 Use ◀▶ on the four-way key to set "On " or "Off". Press "OK" on the four-way key to complete DPOF setting.

- 6 Press menu button to exit.

## ■ Using PictBridge



You can connect the camera directly to a printer that supports PictBridge, and perform image selection and printing using the camera monitor screen and controls.

PictBridge is a standard established by the Camera and Image Products Association (CIPA).

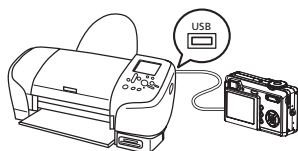

- 1 In the SETUP mode, set USB as PictBridge. (See Page 92)



- 2 Use the USB cable that comes with the camera to connect the camera to a PictBridge compatible printer. After connecting both, the camera LCD monitor will display as in the left figure.

- 3 Press ▲ or ▼ to select "One", then press "OK".



- 4 Press ▲ or ▼ setup copies.

## Chapter 3: Playback images and Video Clips



- 5 If you want to print another picture, press the Menu button and use ◀, ▲, ▶, ▼ and "T/W" button to select which you want. Then press the menu button again, follow STEP 3 and STEP 4 to print a single picture.



- 6 In the print menu, press ▲ or ▼ to select "All", then press "OK". You will print all of the images.



- 8 The LCD monitor will display all the images and copies all you print.



- 9 In the print menu, press ▲ or ▼ to select "DPOF" then press "OK".



**10** LCD monitor will display all the images and copies you print.



**11** With no setting in DPOF , you should redo DPOF setup, See Page. 63: Setup DPOF

*Note 1: See the documentation that comes with your printer for information about print quality and paper settings.*

*Note 2 : Contact your printer manufacturer for information about models that support PictBridge, upgrades, etc.*

*Note 3 : Never disconnect the USB cable, or perform any camera or USB cradle operation while printing is in progress. Doing so causes a printing error.*

### ■ Displaying a Slide Show

When reviewing still pictures, you can adjust some settings here and the camera automatically displays the pictures one by one on the LCD monitor.



- 1 In the playback menu, Press ◀▶ SLIDE SHOW "P" and press "OK" button.

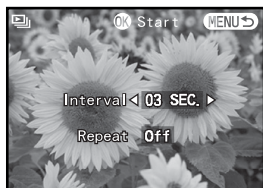

- 2 Pressing ▲ or ▼ to select "Interval" or "Repeat". Use ◀▶ on the four-way key to select interval time (1 sec, 3 sec, 5 sec, 10 sec, 30 sec). Use ◀▶ on the four-way key to select "Repeat" mode: "On" or "Off".



- 3 Press "OK" to confirm the setting and start slide show. Press ▼ button to pause slide show, and press ▼ button to continue slide show.

*Note: During the slide show, press "OK" to stop it.*

## ■ Rotating the Images

This option in the playback menu allows you to rotate the images.

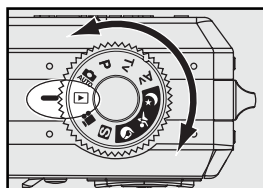

- 1 In the playback mode "▶", Press ◀ or ▶ to select picture. Press "Menu" button to enter playback menu.

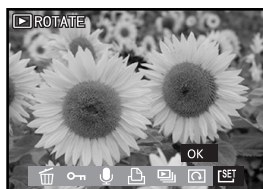

- 2 In the playback menu, select ROTATE "◻" and then press "OK" .



- 3 Press "◀" or "▶", image will rotate clockwise or counterclockwise 90° per pressing.
- 4 Press "OK" to rotate the image again or "Menu" button to return to the playback menu.

*Note : This function only can only be used in the single playback mode.*

### ■ Selecting Your Start-up Screen Photo

This option allows you to define your own start-up screen.

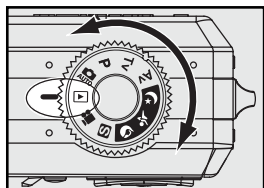

- 1 In the playback mode "▶", Press ◀ or ▶ to select the picture to be the start-up screen. Press "Menu" button to enter playback menu.



- 2 In the playback menu, select START-UP SCREEN "SET" and then press "OK". The current picture will be saved into the camera as a "User Defined" start-up screen.

*Note : You also have to select the User Define option at start-up screen in Setup Mode to activate this completed feature. (See page 91.)*



## **Chapter 4**

# **Installing the Software**

The software CD supplied with the camera includes the driver and the application (PhotoImpression, QuickTime and VideoImpression). The application allows you to upload the images from the camera, view them, print them, and e-mail them. Please install the software before you connect the camera to the computer.

## **Windows System Requirements**

- **Windows 98SE, ME, 2000, and XP**
- **Pentium II processor or greater**
- **32MB of available RAM**
- **110MB of available hard disk space**
- **CD-ROM drive**
- **USB port**
- **Colour Monitor with a minimum resolution of 800 x 600 pixels**

# Installing the Software

## ■ Installing the Driver

If you use Windows 98 SE, install the driver first by following the on-screen instruction.



1 Insert the installation CD-ROM. After you insert the CD into the CD-ROM drive, the first Install window will appear. If the install window does not appear, click "Start" and then "Run". Type "E:\MEDION.exe" E is the drive letter that contains the software CD.

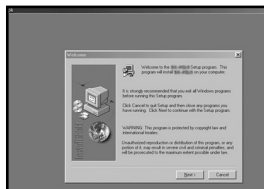

2 Click "Driver".

3 Click "Next".

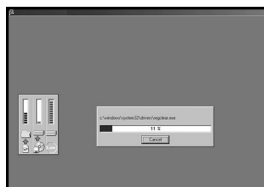

4 The installation starts.

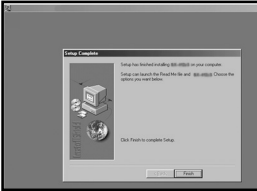

- 5 Click "Finish " to complete the installation. Windows ME, 2000, and XP users do not need to install this driver.



- 6 Click "OK" to complete the installation.

- 7 Restart your computer.

### ■ Installing the Application ( Windows )

1 Turn on the computer and then insert the software CD into the CD-ROM drive.



2 After you insert the CD into the CD-ROM drive, the first Install window will appear. If the install window does not appear, click "Start" and then "Run". Type "E:\MEDION.exe" E is the drive letter that contains the software CD. Click "PhotoImpression".



3 Select a language and click "Next". Follow the on-screen instruction to continue the installation.

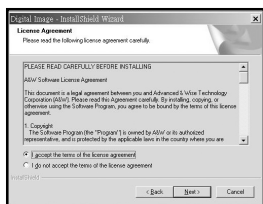

4 Accept the license agreement and then click "Next".

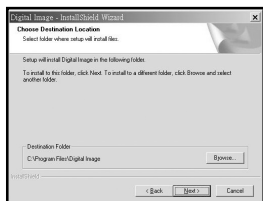

5 Select Program Folder and click "Next". Follow the on-screen instruction to continue and finish the installation.



6 The computer proceeds to install Photolmpression. Select a language and click "OK". Follow the on-screen instruction to continue the installation.

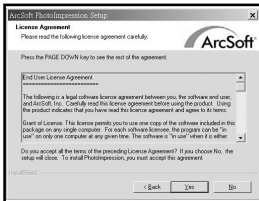

7 Accept the license agreement and then click "Yes".

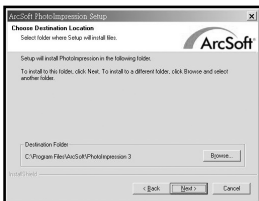

8 Click "Next".

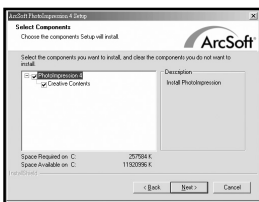

9 Click "Next". Follow the on-screen instruction to continue and finish the installation.

## Chapter 4: Installing the Software

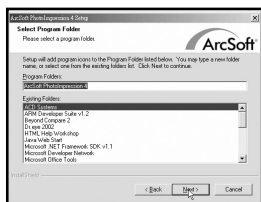

10 Select Program Folder.

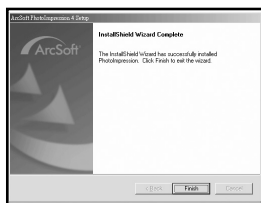

11 Setup complete. Restart the computer.

*Note: Follow step 6~11 to install QuickTime and VideoImpression by clicking "QuickTime • VideoImpression".  
(Please install Apple QuickTime 6.0 or above to allow VideoImpression to support .mov files.)*

## Using the Application

### ■ PhotoImpression

1 Connect the camera to the computer.  
See page 80.

2 Launch PhotoImpression.

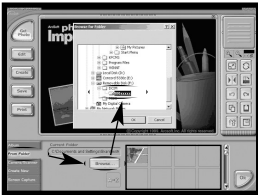

3 To download the images from the camera, select "From Folder", "Browse", "Removable Disk", "Dcim", "100xxxxx", and click "Ok". Click the image that you want to edit in the frame.



4 You can open two images at the same time.

### ■ VideoImpression

- 1 Connect the camera to the computer. See page 80.

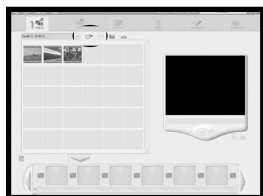

- 2 Launch VideoImpression and then select "add".

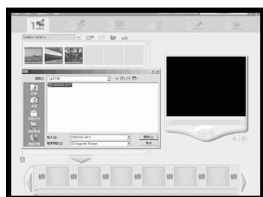

- 3 Select "DCIM" to download the video clips from the camera.

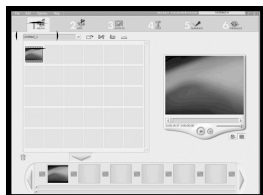

- 4 Double-click to select the video chips.





5 Click "Play" to play the video clips.

## Chapter 5

# Uploading, Printing and Displaying Images

After you take pictures, you can upload images to a computer from your camera, print them with a printer, and display them on TV.

### Uploading to a Computer

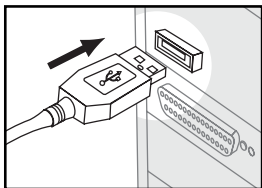

- 1 Connect the larger end of the USB cable to the USB slot of computer.

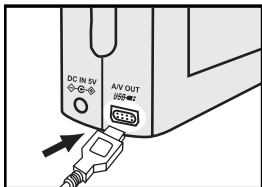

- 2 In any mode, connect the small end of the USB cable to the camera.
- 3 The computer automatically detects the camera as a mass storage device so that you can copy the image file from your camera to the hard drive of a computer.

*Note 1: Upon connecting the camera to a computer, the LCD monitor turns off automatically.*

*Note 2: If you use Windows 98SE you have to install USB driver from the software CD-ROM (see page 72).*

## **Printing Images**

After uploading the images to a computer, you can print them by using the software supplied with the camera. You can also connect the camera directly to some specific standalone photo printers. To connect the printer:

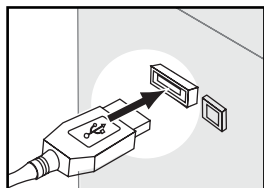

- 1 Get the USB cable and connect the larger end of it to the printer.

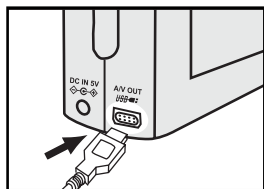

- 2 In any mode, connect the small end of the USB cable to the camera.
- 3 Adjust the settings of DPOF in the Playback Menu. See page 63.

### Displaying Images on a TV

By connecting to a TV, you can view images as a slide show and play audio/video clips.

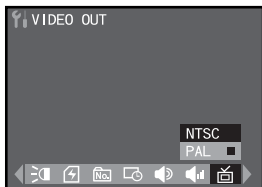

- 1 Select the right TV system in "Set Up" mode. See page 89.

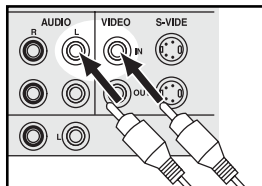

- 2 Connect the AV (Audio/Video) cable to the AV inputs of a TV.

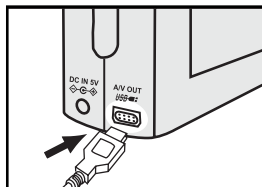

- 3 Connect the AV cable to the AV connector of the camera.

*Note 1: When you connect your camera to a TV, the LCD monitor turns off automatically.*

*Note 2: The audio terminal is white and the video terminal is yellow.*

## Chapter 6

### Adjusting the Camera Settings

Set up mode allows you to adjust the default settings of this camera.

## Using the Set Up Menu

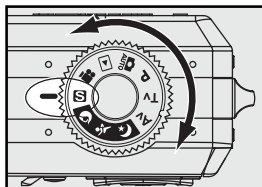

- 1 Rotate the mode dial to Set-Up "S".

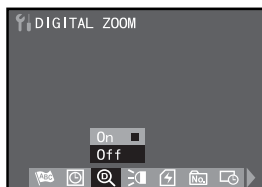

2 Use ◀▶ on the four-way key to scroll through the menu and press ▲▼ on the four-way key to scroll through the submenu.

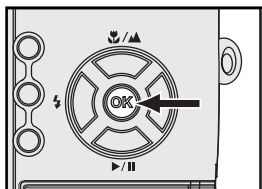

3 Press "OK" to confirm the setting.

*Note: Language and Date/Time settings, please see page 19-20.*

### ■ Setting Digital Zoom

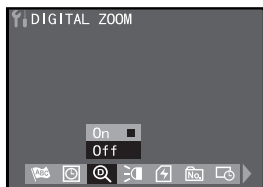

1 Rotate the mode dial to Set-Up "S" mode. In the Set-Up menu, press ◀ or ▶ to select DIGITAL ZOOM "ⓧ".

2 Press ▲ or ▼ to select "On" or "Off".

3 Press "OK" button to confirm the setting.

### ■ Setting AF Illuminator



1 Rotate the mode dial to Set-up Set-Up "S" mode. In the Set-Up menu, Press ◀ or ▶ to select AF ILLUMINATOR "ⓧ".

2 Press ▲ or ▼ to select "Auto" or "Off".

3 Press "OK" button to confirm the setting.

## ■ Format the Memory Card

This function allows you to delete all of the images, data, information, and folders on your memory card.

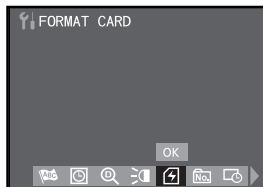

- 1 Rotate the mode dial to Set-Up "S" mode. In the Set-Up menu, press ◀ or ▶ to select FORMAT CARD "⚡". And press "OK" button.

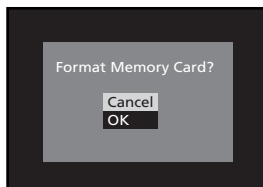

- 2 A confirmation dialog will be displayed. Press ▲ or ▼ to select "OK" to format the memory card.

*Note: This camera supports 16MB ~ 1GB SD card.*

### ■ Resetting File Number

When using this camera, the data file numbers are accumulated when taking photos or recording video clips. This is to avoid repeating file names, if you want to move the photos which you stored on different memory cards into the same folder in your PC. With this function, you could reset the file number and the camera will name/number the photos continuing from the last image saved on the memory card.

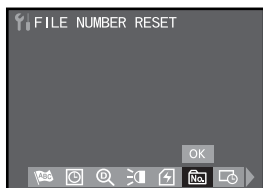

- 1 Rotate the mode dial to Set-Up "S" mode. In the Set-Up menu, press ◀ or ▶ to select FILE NUMBER RESET "No.". And press "OK" button.

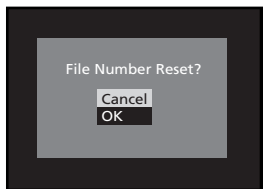

- 2 A confirmation dialog will be displayed. Press ▲ or ▼ to select "OK" to reset file number.



## ■ Imprinting the Date and Time

When printing your images out or displaying pictures, you can select whether to imprint the date & time on the pictures or not.

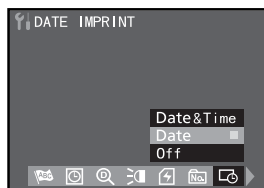

- 1 Rotate the mode dial to Set-Up "**S**" mode. In the Set-Up menu, press ◀ or ▶ to select DATE IMPRINT "🔍".
- 2 Press ▲ or ▼ to select "Date & Time", "Date", or "Off".
- 3 Press "OK" button to confirm the setting.

### ■ Setting Camera Sound

This function allows you to hear a beep sound effect when pressing the buttons.

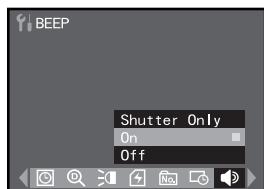

- 1 Rotate the mode dial to Set-Up "S" mode. In the Set-Up menu, press ◀ or ▶ to select BEEP " 🔊 ".  
2 Press ▲ or ▼ to select "Shutter Only", "On" or "Off".  
3 Press "OK" to confirm the setting.

### ■ Setting Camera Volume

Set the volume of the tone when using the camera.

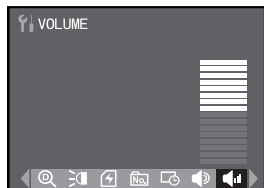

- 1 Rotate the mode dial to Set-Up "S" mode. In the Set-Up menu, press ◀ or ▶ to select VOLUME " 🔊 ".  
2 Use ▲▼ on the four-way key to adjust the volume.  
3 Press "OK" to confirm the setting.

## ■ Setting TV System

Both NTSC and PAL are TV's broadcast systems. The NTSC system is mainly used in U.S.A., Japan, Canada, Mexico, Philippines, and Korea. The PAL system is used in Western Europe such as Germany, England, Switzerland, Netherlands, Italy; also in Australia, Singapore, Thailand and China.

As these systems are not compatible, you cannot watch an NTSC system based TV in an area where a PAL system is used.

This camera can switch the video output signal to NTSC system and PAL system. So you can watch the images on TV not only in your own country, but around the world.

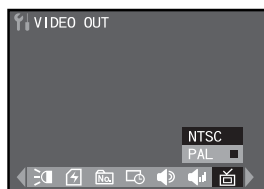

- 1 Rotate the mode dial to Set-Up "S" mode. In the Set-Up menu, press ◀ or ▶ to select VIDEO OUT "📺".
- 2 Press ▲ or ▼ to select "NTSC" or "PAL".
- 3 Press "OK" to confirm the setting.

*Note: Image will be black and white on the TV screen if you choose the wrong TV system.*

### ■ Setting Power Saving Function

To conserve the battery power, the camera turns off automatically when has not been in use for 1~10 minutes.

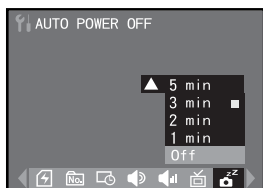

1 Rotate the mode dial to Set-Up "S" mode.  
In the Set-Up menu, press ◀ or ▶ to select  
AUTO POWER OFF "zz".

2 Press ▲ or ▼ to select "off", "1 min",  
"2 min", "3 min", "5 min" or "10 min".

3 Press "OK" button to confirm the setting.

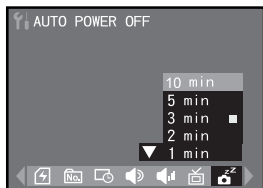

## ■ Customizing Your Start-Up Screen

When you turn on the camera, LCD monitor will display the "Start-Up Screen" you can customise it use any image that you have captured.

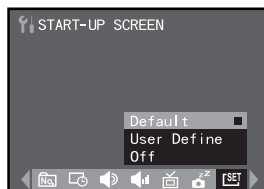

- 1 Rotate the mode dial to Set-Up "S" mode. In the Set-Up menu, press ◀ or ▶ to select START-UP SCREEN "SET".
- 2 Press ▲ or ▼ to select "OFF", "Default" or "User Define".
- 3 Press "OK" to confirm the setting.

*Note : The "User Define" picture is selected in "Selecting your Set-Up screen Photo" on page 67.*

### ■ Setting the USB connection mode

You can change the USB connection mode depending on whether the USB cable is to be connected to a printer (PICTBRIDGE) or a computer (STORAGE).



1 Rotate the mode dial to Set-Up "S" mode.  
In the Set-Up menu press ◀ or ▶ to select  
USB "  ".

2 Press ▲ or ▼ to select "STORAGE" or  
"PICTBRIDGE".

3 Press "OK" to confirm the setting.

*Note : Select PictBridge mode ,  
please see page 65.*

## ■ Resetting Your Camera

You can restore the settings to default by using the "Reset" function.

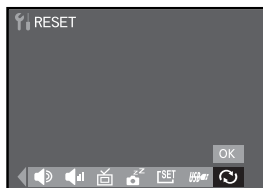

- 1 Rotate the mode dial to Set-Up "S" mode. In the Set-Up menu, press ◀ or ▶ to select RESET "↺". And press "OK" button.

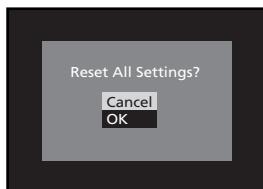

- 2 A confirmation dialog will be displayed. Press ▲ or ▼ to select "OK" and press "OK" button to reset the setting.

Setting	Default
Image Size	2848 x 2136
Picture Quality	Fine
EV Value	0.0
Capture Mode	Single
White Balance	Auto
Exposure Area	Central
ISO	Auto
Sharpness	Medium
Saturation	Normal
Picture Effect	Normal

Setting	Default
Self-timer	Off
Focus Mode	Auto
Slide Show Interval	3 Sec
Auto Power Off	3 Min
Beep	On
Video Out	PAL
Language	English

# Trouble Shooting

Problem	Possible Cause	Solution
The camera does not work	The power is off	Press the power button to turn it on
	The battery is inserted incorrectly	Reload the battery correctly
	The battery is low or drained	Replace battery with new one
The picture cannot be taken when I press the shutter release button of the camera	The camera is not in capture mode	Rotate the mode dial to capture mode
	You did not press the shutter release button down enough	Press the shutter release button all the way down
	The memory card is full	Insert another memory card, upload the images to a computer or delete some of the images
	The camera is still saving the last image you took	Wait until image storing of the camera is finished
	The flash is still recharging	Wait for a few seconds until recharging is completed
	The battery is low	Replace battery with new one
	You did not insert the memory card	Insert the memory card
The flash does not fire	The battery power is low	Replace battery with new one
	The flash is off	Switch to other flash mode



## *Trouble Shooting*

<b>Problem</b>	<b>Possible Cause</b>	<b>Solution</b>
The images are blurry	The camera was moved when you pressed the shutter release button	Hold the camera steady or use a tripod when taking pictures
	The focus brackets are not positioned on the subject	Position the focus brackets on your subject
	Use macro mode to shoot subjects within normal focus, or vice versa	Set the camera to shoot in normal focus or macro focus and then take the picture again
	The light is low and the flash is off	Use a tripod and turn on the flash
	The lens is dirty	Softly clean the lens
The images are too bright	The flash is on when the subject is bright enough	Turn off the flash
	Too close to the subject when taking pictures with the flash on	Move back from the subject and take the picture again
	Subject is much brighter than the background	Avoid pointing the camera to bright light sources and use exposure compensation
The images are too dark	The flash is off	Turn on the flash
	The subject is in dark	Turn on the flash

# Specifications

## Type

- Recording media exchangeable 3x zoom digital camera with LCD monitor

## Effective Pixels

- [Total] 6.36M pix
- [Image] 6.20M pix

## Image Capture Unit

- Sensor : 1/1.8 inch-type interline CCD
- Image Size : 2848 x 2136 [Full]  
2560 x 1920 [Large]  
2272 x 1704 [Medium]  
2048 x 1536 [Small]  
640 x 480 [VGA]  
320x224 [Movie]

## Lens

- Focal length : f=7.3-21.9 mm (35mm camera format  
equivalent : 35-105mm)
- f/-number : f/2.8 (Wide) - f/4.9 (Tele)
- Distance : 30cm-infinity
- Macro : 3cm - 30cm (wide only)

## Digital Zoom

- 7 x

## Auto Focus (AF)

- Focusing type : TTL CCD AF
- AF sensing range : LV5 ~ LV16 (Wide), LV6 ~ LV1.6 (Tele)
- AF area : Central weighted

## Specifications

### Viewfinder

- Real image optical viewfinder

### Monitor

- 2.0" LTPS color LCD
- Frame coverage : approx. 90% ~ 100%

### Shutter

- 1/2000 - 2 sec , electro-mechanical and charge-coupled shutter plus aperture control.

### Exposure

- Exposure mode      Auto / Program AE/ Aperture priority/ Shutter priority /  
   Night Shot / Sports / Portrait / Landscape
- Metering mode      Full Area / Central
- Exposure Compensation    +/- 2.0 Ev (1/3 Ev Step)

### Sensitivity

- ISO equivalent approximately 100, 200, 400 or Auto

### Self timer

- 2sec , 5sec or 10 sec

### Build-in Flash

- Auto control built-in type
- Range                      Wide: 0.5m – 3.0m  
   Tele: 0.5m – 2.5m

### Storage

- Internal Memory    no
- Medium                SD memory card (*This camera supports 16 MB ~ 1 GB SD card*)
- Image file type      DCF v1.0, Exif v2.2, DPOF v1.1,  
   MPEG 4

## *Specifications*

### **I/O External**

- DC input DC 5V adaptor
- Video output NTSC and PAL (selectable)
- PC connection Mini-plug type USB, mini USB connector for serial cable  
AV / USB Comb connector

### **Power Sources**

- Li-ion battery.
- AC adaptor (DC 5 volt) / AC adaptor, Mode name : DSA-01 01F-05 UP

### **Dimensions**

- Size 102mm x 62mm x 35.5mm
- Weight 180 grams (without battery)

### **System Requirements: Windows**

- CPU Pentium II or more
- Memory At least 32MB
- OS Windows 98SE / Windows ME /  
Windows 2000 / Windows XP
- Interface USB 1.0 / 1.1
- VGA color monitor
- CD-ROM